



Call for Price

1 Elevations Available

	4,450
	5
	4.5
	2
	2

The Cypress home plan features 5 bedrooms, 4.25 baths and 4,450 sq feet of open living space. As you enter through the covered porch and double door entry, you are greeted by a spectacular curved staircase and a grand foyer which is open to the upstairs. With ten-foot-high ceilings and large windows throughout the main floor, you cannot help but notice the open and spacious feel of this floor plan.

The Formal Dining Room offers a coffered ceiling and crown moldings for a classic touch. The butlers pantry provides direct access to the kitchen from the dining room. It also allows for additional prep space, storage, and includes a beautiful under counter wine fridge.

If you choose to spend your time in the gorgeous gourmet kitchen, notice the commercial grade stainless steel style appliances and over-sized island slab which is great for meal prepping, informal meals or doing homework. Adjacent to the kitchen is a nook which is a great space for entertaining or a kid's space. From the nook, you will find access to the covered patio or you can go into the great room and cozy up and relax next to the gas fireplace.

The main floor includes a Guest Suite that is a perfect place for visiting family or friends. This Suite is adjacent to a bathroom which features a tiled shower and designer finishing touches to help create a private getaway for your guests.

As you head up the curved staircase to the upper floor of this home, you will be impressed as you enter the Master Ensuite and all of the natural light it gives. As you head into the Master Bathroom, notice the double vanity, large soaking tub and beautiful designer tiled shower. The perfect way to end your day! This floor also features an additional 3 bedrooms, 2 full bathrooms, a laundry room and an over-sized bonus room.



AmericanClassicHomes.com

Pricing, features, and availability are subject to change without notice. American Classic Homes makes reasonable efforts to provide accurate information, however, no warranties or representations are made as to its accuracy and American Classic Homes assumes no liability or responsibility for any errors in pricing content. All pricing information, including promotions and incentives, must be verified by an authorized representative for the appropriate community and home. Photography, floor plans, elevations, renderings, virtual tours, maps, square footage, and dimensions are approximate and for illustration purposes only, and will vary from homes as built and are subject to change without notice. Homes in each neighborhood may be owned and sold by a separate limited liability company (LLC) or other corporate entity.



The Cypress 4450

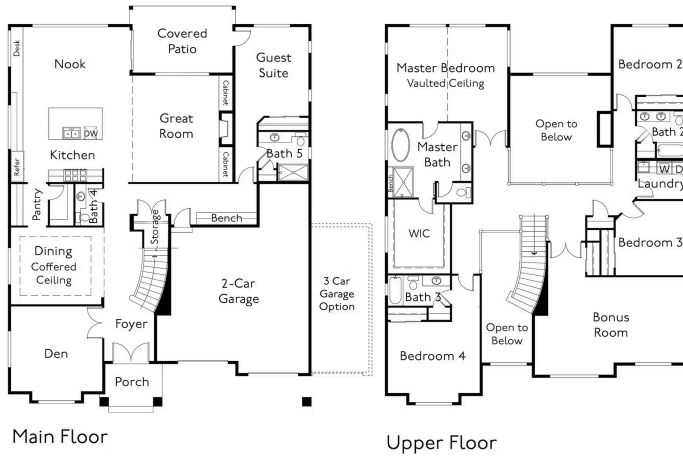

www.AmericanClassicHomes.com
Renderings and floor plans are artist's concept and for illustrative purposes only. Standard features may vary by community. Floor plans, dimensions, garages and patios may not be available in all communities upon all home sites. In a continuing effort provide a quality product, we reserve the right to change floor plans, elevations, specifications and prices without notice.



AmericanClassicHomes.com

Pricing, features, and availability are subject to change without notice. American Classic Homes makes reasonable efforts to provide accurate information, however, no warranties or representations are made as to its accuracy and American Classic Homes assumes no liability or responsibility for any errors in pricing content. All pricing information, including promotions and incentives, must be verified by an authorized representative for the appropriate community and home. Photography, floor plans, elevations, renderings, virtual tours, maps, square footage, and dimensions are approximate and for illustration purposes only, and will vary from homes as built and are subject to change without notice. Homes in each neighborhood may be owned and sold by a separate limited liability company (LLC) or other corporate entity.